



FIG. 1. ATR ASSEMBLED

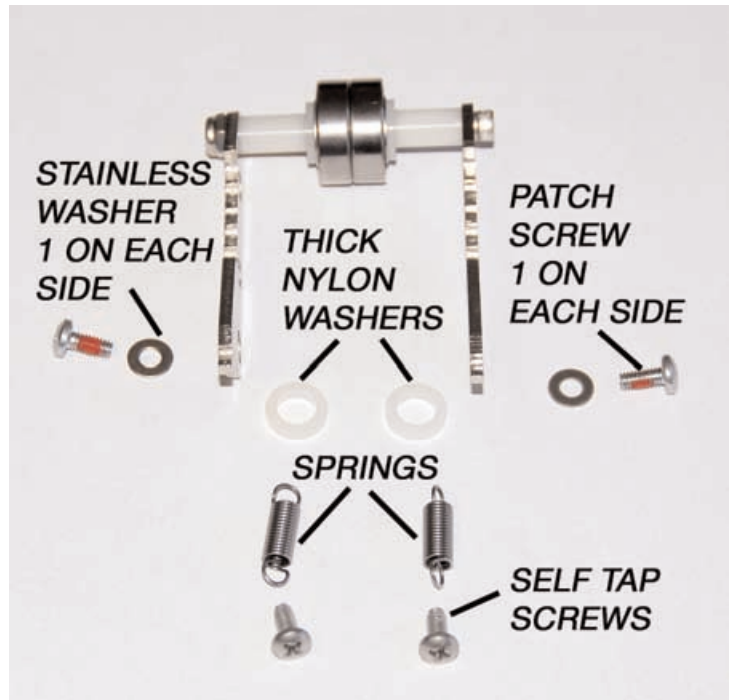

FIG. 2 ROLLER ARM COMPONENTS

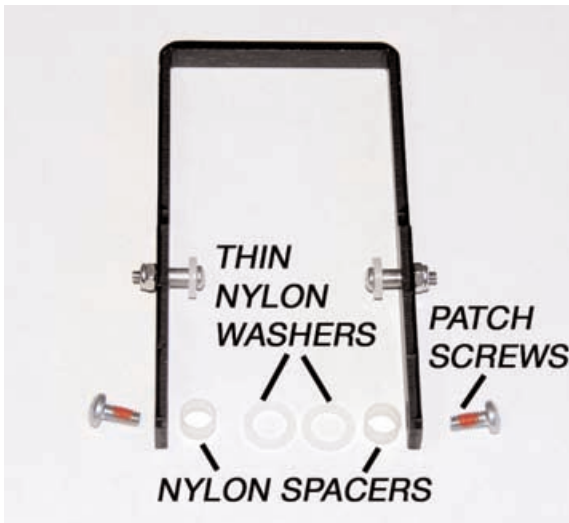

FIG.3 LEVER ARM COMPONENTS

V2 JENEX INC.  
 172 SOUTH ST MILFORD, NH 03055  
 TEL. 603-672-2600 www.jenex.com  
**Caution! Like most sports, roller skiing can be dangerous. Always wear protective gear and ski in places that are safe and away from traffic .**

Tools required: A # 2 Phillips Screw Driver and preferably a vise to hold the ski.

**Roller Arm:** Place the thick nylon washers, shown in Figure 2, over the Pem standoffs in the wheel fork (see Figure 1 for location) and place the bearing roller arm assembly over the stainless steel stand-offs. Next put the stainless steel washers onto the Patch Screws and install the screws with a #2 Phillips Screw Driver.

**Installing the Springs:** Place one end of the Spring over the self tap Screw and install the screw so the thread of the screw is protruding approximately 1.5 mm ( 1/16 inch ) on the inside of the wheel fork. ( An electric screw driver is very handy when installing self tapping screws.) Next pull the Roller Arm towards the front of the wheel and attach the other end of the spring to the "hook" in the roller arm as shown in Figure 1.

**2- ATR Lever:** Put the thin nylon washers over the Pem Standoff. (See Figure 1 for location.) Next put the nylon spacers over the Pem standoff and put the pivot holes in the lever over the Pem Standoffs. Secure the lever with the two Patch screws shown in Figure 3.

**How to use the ATR:** To engage simply pull the lever towards you. If the wheels are new and not worn do not use the maximum resistance position. For better durability and ease of use, lubricate the detent's in the roller arm assembly.